

AGPTEK

User Manual

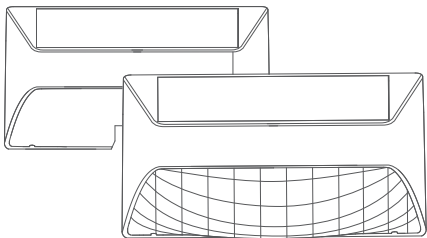

OUTDOOR FENCE LIGHT

Model: CDN-KF04A-RGB

Before Use

Please read this **【User Manual】** carefully before use and keep it for future reference.

For first use, please place it on somewhere with direct and sufficient sunlight to charge for 6–8 hours.

Important Tips: The charging time and charging efficiency of solar panel will be affected by weather and installation position. It is recommended to install in a place exposed to sunlight.

Product Distribution Diagram

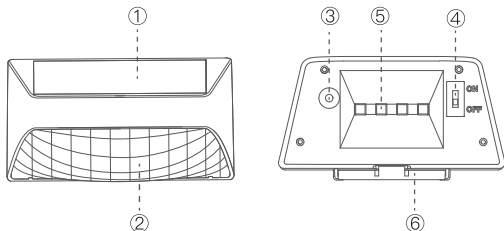

- ① Solar Panel
- ② Lampshade
- ③ Mode Button

- ④ Power Switch
- ⑤ LED Light Bead
- ⑥ Screw Plate

Packing List

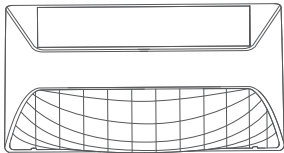

Solar Light

Screws Kit

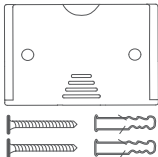

Screw Plate

Working Mode

Under working mode, the light color is changed by warm white, RGB fade, RGB flash, white, red, green, cyan-blue, yellow, blue, purple, cycling in turn.

Warm Tip: With memory function, when you turn on the light again, it is the last color you has used.

Installation Steps

Before installation, please turn on the switch and cover the solar panel with your hand to check whether the light can be turned on.

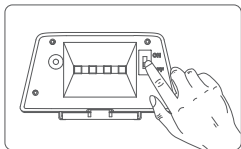

① Push the switch to “ON” position to turn on.

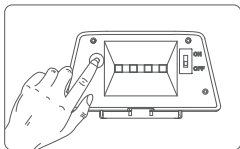

② Choose the mode you favor.

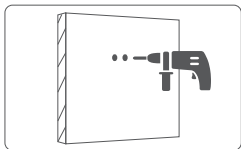

③ Drill appropriate holes in the wall.

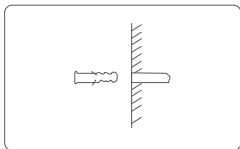

④ Insert expansion bolts.

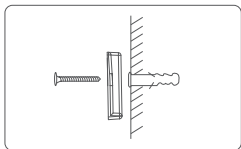

⑤ Tighten the screw plate with screws.

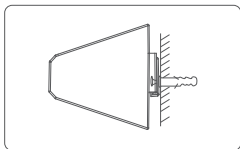

⑥ Put the light into the screw plate.

Lampshade Installation and Removal Method

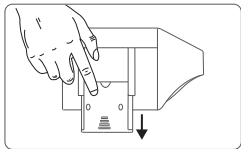

① Remove the screw plate

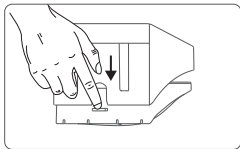

② Remove the lampshade

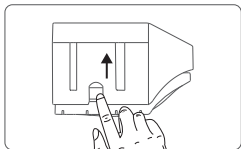

③ Install the lampshade

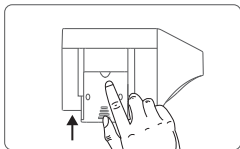

④ Install on the screw plate

Specifications

| | |
|---------------------|-------------------------|
| Solar Panel | Monocrystalline Silicon |
| Solar Power | 5V/150mA 0.75W |
| Battery Capacity | 3.7V/1200mAh |
| Material | PC+ABS |
| Charging Time | 6-8H |
| Working Time | 20H |
| Working Temperature | -20°C~70°C (-4°F~158°F) |

Unsuitable Installation Environment

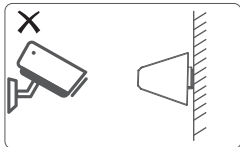

- × Monitoring area.
Because the infrared rays will affect the normal operation of the solar light.

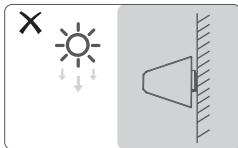

- × Somewhere with short lighting time. Please install the light in a location that receive full sunlight each day for at least 5 hours.

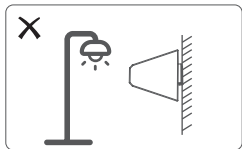

- × Somewhere with bright light. Because the light will automatically turn off like at daytime, not light up.

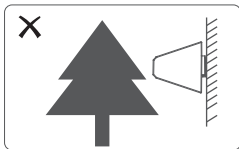

- × Somewhere under shade. Cannot be installed in the shade of trees and other places where sunlight cannot reach, or will affect the charging efficiency.

Attention

1. If the product is not used for a long time, please place it on somewhere with direct and sufficient sunlight to charge for a day. To maintain the battery, it is best to keep it in a sunny place every month.
2. Please keep the switch on when charging.
3. Avoid long-term use in high temperature, high humidity and corrosive environment, or it will affect the service life of the product.
4. The product is waterproof in rainy and humid environment, but do not immerse it in water.
5. Please do not put the battery into fire to avoid explosion.

Maintenance

1. Please keep the solar panel clean and regularly wipe off the surface with a damp cloth, as excessive dust or debris will reduce the charging efficiency of the solar panel.
2. In heavy snow days, need to clean the solar panel in time to avoid snow and ice on the surface of solar panel affecting normal work.

Troubleshooting

| Trouble | Reason Analysis | Solution |
|------------------------------|---|--|
| Does not work after charging | The switch is OFF when charging. | Turn on the switch and recharge. |
| | The solar panel is too close to other light sources. | Cover the solar panel with your hand for testing, if lights up, please move and install the light to other places. |
| | Defective battery. | Please contact us for help. |
| Does not light up at night | Confirm whether the installation environment has sufficient light during the day. | Install in a place that can get enough sunlight, and no shelter between 9:00–15:00 every day. |

| | | |
|--|--|---|
| | Check whether install in a place exposed to bright light or infrared rays. | Please place it away from areas with bright light or infrared rays. |
| Short working time | Does not get enough sunlight to recharge due to installation in a shady place or charging on a cloudy day. | Please install it in a place with direct and sufficient sunlight; If does not get enough sunlight on a cloudy or rainy day, will automatically return to the best working state after the weather returns to sunny. |
| | Solar panel is covered with dust or debris, influencing the charging efficiency. | Clean solar panel regularly to ensure adequate sun exposure. |
| Stop working after a short time (weeks/months) | Does not get enough sunlight for a long time. | The solar panel needs to be installed in a place with direct sunlight, and cannot be installed in somewhere under shade or eaves. |
| | Water leaks after heavy rain or snow. | Please contact us for help. |
| | Defective battery. | |

